



****AVAILABLE OCTOBER 2025** **ONE
BEDROOM APARTMENT** **FURNISHED****

A well-presented and stylish, second floor apartment with pleasant outlook in Wrendale Court, South Gosforth. This modern development, built by Persimmon in 2007, is tucked off Bowsden Terrace and ideally located for easy access to South Gosforth Metro Station and the amenities of Gosforth High Street.



The accommodation comprises: communal entrance with a secure telephone entry system, private entrance hall with built in storage, a 21ft open plan living/dining/kitchen area with contemporary kitchen and integrated appliances, double bedroom with dual aspect and a stylish, modern shower room with generous shower and complimentary tiling. Externally the property is found in pleasant surroundings, with one allocated parking space, a communal secure bicycle and bin storage. With UPVC double-glazed windows, this great apartment demands an early internal inspection.

Available 3rd October 2025 | £795pcm |
Furnished | Second Floor Apartment | 447 Sq ft
(41.5m²) | 21ft Open Plan Living Space | One
Double Bedroom | Kitchen with Integrated
Appliances | Modern Shower Room WC |
Allocated Parking | Great Location | Stylish
Presentation | Council Tax Band: A | EPC Rating:
C

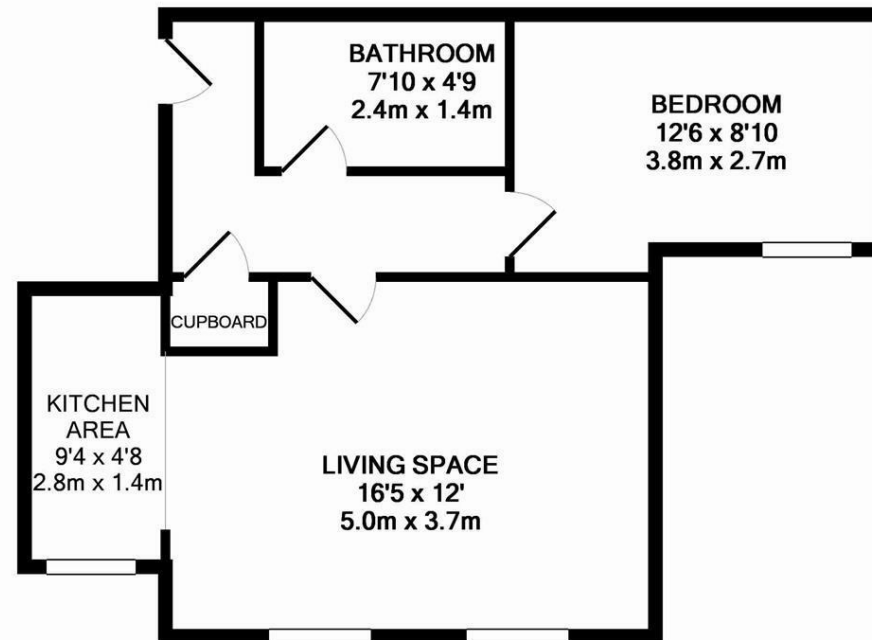

TOTAL APPROX. FLOOR AREA 447 SQ.FT. (41.5 SQ.M.)



Whilst every attempt has been made to ensure the accuracy of the floor plan contained here, measurements of doors, windows, rooms and any other items are approximate and no responsibility is taken for any error, omission, or mis-statement. This plan is for illustrative purposes only and should be used as such by any prospective purchaser. The services, systems and appliances shown have not been tested and no guarantee as to their operability or efficiency can be given
Made with Metropix ©2016

£795 PCM

IMPORTANT NOTE: These particulars and the descriptions and measurements herein do not constitute representation and whilst every effort has been made to ensure accuracy, this cannot be guaranteed.

